

# Spine cilindriche Dowel pins

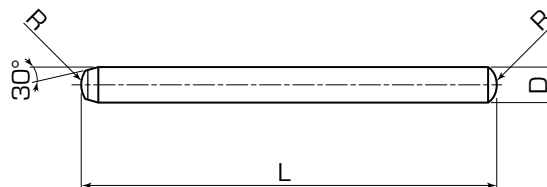

**RO157** Spina cilindrica (DIN6325, UNI6364A) - SC  
Dowel pin (DIN6325, UNI6364A) - SC



**Descrizione:**

Materiale: Acciaio per utensili Temprato  
Tolleranza di rettifica: "m6" e "h6"  
Esempio di ordinativo: RO157-01-0001

**Description:**

Material: Hardened Tool Steel  
Tolerance: "m6" and "h6"  
Example of purchasing order: RO157-01-0001

| Codice Code | Tol. D | L  | D    |      |      |      |      |      |      |      |      |      |      |    |    |    |    |  |
|-------------|--------|----|------|------|------|------|------|------|------|------|------|------|------|----|----|----|----|--|
|             |        |    | 1    | 1.5  | 2    | 2.5  | 3    | 4    | 5    | 6    | 8    | 10   | 12   | 14 | 16 | 18 | 20 |  |
| RO157-01    | m6     | 4  | 0002 |      |      |      |      |      |      |      |      |      |      |    |    |    |    |  |
| RO157-01    | m6     | 5  | 0004 | 0014 |      |      |      |      |      |      |      |      |      |    |    |    |    |  |
| RO157-01    | h6     | 6  |      |      | 0033 |      |      | 0081 | 0109 |      |      |      |      |    |    |    |    |  |
| RO157-01    | m6     | 6  | 0006 | 0016 | 0034 | 0058 | 0082 | 0110 |      |      |      |      |      |    |    |    |    |  |
| RO157-01    | h6     | 8  |      |      | 0035 |      | 0083 | 0111 | 0145 |      |      |      |      |    |    |    |    |  |
| RO157-01    | m6     | 8  | 0008 | 0018 | 0036 | 0060 | 0084 | 0112 | 0146 |      |      |      |      |    |    |    |    |  |
| RO157-01    | h6     | 10 |      |      | 0037 |      | 0085 | 0113 | 0147 | 0184 |      |      |      |    |    |    |    |  |
| RO157-01    | m6     | 10 | 0010 | 0020 | 0038 | 0062 | 0086 | 0114 | 0148 | 0185 |      |      |      |    |    |    |    |  |
| RO157-01    | h6     | 12 |      |      | 0039 |      | 0087 | 0115 | 0149 | 0186 |      |      |      |    |    |    |    |  |
| RO157-01    | m6     | 12 | 0012 | 0022 | 0040 | 0064 | 0088 | 0116 | 0150 | 0187 |      |      |      |    |    |    |    |  |
| RO157-01    | h6     | 14 |      |      | 0041 |      | 0089 | 0117 | 0151 | 0188 |      |      |      |    |    |    |    |  |
| RO157-01    | m6     | 14 |      | 0024 | 0042 | 0066 | 0090 | 0118 | 0152 | 0189 |      |      |      |    |    |    |    |  |
| RO157-01    | h6     | 16 |      |      | 0043 |      | 0091 | 0119 | 0153 | 0190 | 0222 |      |      |    |    |    |    |  |
| RO157-01    | m6     | 16 |      | 0026 | 0044 | 0068 | 0092 | 0120 | 0154 | 0191 | 0223 |      |      |    |    |    |    |  |
| RO157-01    | h6     | 18 |      |      | 0045 |      | 0093 | 0121 | 0155 | 0192 | 0224 | 0256 |      |    |    |    |    |  |
| RO157-01    | m6     | 18 |      | 0028 | 0046 | 0070 | 0094 | 0122 | 0156 | 0193 | 0225 | 0257 |      |    |    |    |    |  |
| RO157-01    | h6     | 20 |      |      | 0047 |      | 0095 | 0123 | 0157 | 0194 | 0226 | 0258 | 0290 |    |    |    |    |  |
| RO157-01    | m6     | 20 |      | 0030 | 0048 | 0072 | 0096 | 0124 | 0158 | 0195 | 0227 | 0259 | 0291 |    |    |    |    |  |
| RO157-01    | h6     | 24 |      |      | 0049 |      | 0097 | 0125 | 0159 | 0196 | 0228 | 0260 | 0292 |    |    |    |    |  |
| RO157-01    | m6     | 24 |      | 0032 | 0050 | 0074 | 0098 | 0126 | 0160 | 0197 | 0229 | 0261 | 0293 |    |    |    |    |  |
| RO157-01    | h6     | 28 |      |      | 0051 |      | 0099 | 0127 | 0162 | 0198 | 0230 | 0262 | 0294 |    |    |    |    |  |
| RO157-01    | m6     | 28 |      |      | 0052 | 0076 | 0100 | 0128 | 0163 | 0199 | 0231 | 0263 | 0295 |    |    |    |    |  |
| RO157-01    | h6     | 30 |      |      | 0053 |      | 0101 | 0129 | 0164 | 0200 | 0232 | 0264 | 0296 |    |    |    |    |  |
| RO157-01    | m6     | 30 |      |      | 0054 | 0078 | 0102 | 0130 | 0165 | 0201 | 0233 | 0265 | 0297 |    |    |    |    |  |
| RO157-01    | h6     | 32 |      |      | 0055 |      | 0103 | 0131 | 0166 | 0202 | 0234 | 0266 | 0298 |    |    |    |    |  |
| RO157-01    | m6     | 32 |      |      | 0056 | 0080 | 0104 | 0132 | 0167 | 0203 | 0235 | 0267 | 0299 |    |    |    |    |  |

## R0157 Spina cilindrica (DIN6325, UNI6364A) - SC Dowel pin (DIN6325, UNI6364A) - SC

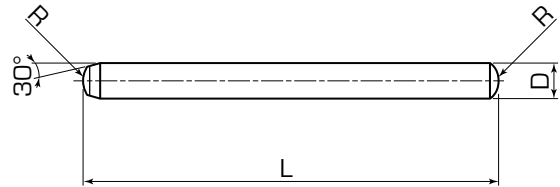

### Descrizione:

Materiale: Acciaio per utensili Temprato  
Tolleranza di rettifica: "m6" e "h6"  
Esempio di ordinativo: R0157-01-0001

### Description:

Material: Hardened Tool Steel  
Tolerance: "m6" and "h6"  
Example of purchasing order: R0157-01-0001

| Codice<br>Code | Tol.<br>D | L   | D |     |   |     |      |      |      |      |      |      |      |      |      |      |      |      |
|----------------|-----------|-----|---|-----|---|-----|------|------|------|------|------|------|------|------|------|------|------|------|
|                |           |     | 1 | 1.5 | 2 | 2.5 | 3    | 4    | 5    | 6    | 8    | 10   | 12   | 14   | 16   | 18   | 20   |      |
| R0157-01       | h6        | 36  |   |     |   |     | 0105 | 0133 | 0168 | 0204 | 0236 | 0268 | 0300 |      |      |      |      |      |
| R0157-01       | m6        | 36  |   |     |   |     | 0106 | 0134 | 0169 | 0205 | 0237 | 0269 | 0301 |      |      |      |      |      |
| R0157-01       | h6        | 40  |   |     |   |     | 0107 | 0135 | 0170 | 0206 | 0238 | 0270 | 0302 | 0326 | 0350 | 0374 | 0398 |      |
| R0157-01       | m6        | 40  |   |     |   |     | 0108 | 0136 | 0171 | 0207 | 0239 | 0271 | 0303 | 0327 | 0351 | 0375 | 0399 |      |
| R0157-01       | h6        | 45  |   |     |   |     |      | 0137 | 0172 | 0208 | 0240 | 0272 | 0304 | 0328 | 0352 | 0376 | 0400 |      |
| R0157-01       | m6        | 45  |   |     |   |     |      | 0138 | 0173 | 0209 | 0241 | 0273 | 0305 | 0329 | 0353 | 0377 | 0401 |      |
| R0157-01       | h6        | 50  |   |     |   |     |      | 0139 | 0174 | 0210 | 0242 | 0274 | 0306 | 0330 | 0354 | 0378 | 0402 |      |
| R0157-01       | m6        | 50  |   |     |   |     |      | 0140 | 0175 | 0211 | 0243 | 0275 | 0307 | 0331 | 0355 | 0379 | 0403 |      |
| R0157-01       | h6        | 55  |   |     |   |     |      | 0141 | 0176 | 0212 | 0244 | 0276 | 0308 | 0332 | 0356 | 0380 | 0404 |      |
| R0157-01       | m6        | 55  |   |     |   |     |      | 0142 | 0177 | 0213 | 0245 | 0277 | 0309 | 0333 | 0357 | 0381 | 0405 |      |
| R0157-01       | h6        | 60  |   |     |   |     |      | 0143 | 0178 | 0214 | 0246 | 0278 | 0310 | 0334 | 0358 | 0382 | 0406 |      |
| R0157-01       | m6        | 60  |   |     |   |     |      | 0144 | 0179 | 0215 | 0247 | 0279 | 0311 | 0335 | 0359 | 0383 | 0407 |      |
| R0157-01       | h6        | 70  |   |     |   |     |      |      | 0180 | 0216 | 0248 | 0280 | 0312 | 0336 | 0360 | 0384 | 0408 |      |
| R0157-01       | m6        | 70  |   |     |   |     |      |      | 0181 | 0217 | 0249 | 0281 | 0313 | 0337 | 0361 | 0385 | 0409 |      |
| R0157-01       | h6        | 80  |   |     |   |     |      |      | 0182 | 0218 | 0250 | 0282 | 0314 | 0338 | 0362 | 0386 | 0410 |      |
| R0157-01       | m6        | 80  |   |     |   |     |      |      | 0183 | 0219 | 0251 | 0283 | 0315 | 0339 | 0363 | 0387 | 0411 |      |
| R0157-01       | h6        | 90  |   |     |   |     |      |      |      | 0220 | 0252 | 0284 | 0316 | 0340 | 0364 | 0388 | 0412 |      |
| R0157-01       | m6        | 90  |   |     |   |     |      |      |      | 0221 | 0253 | 0285 | 0317 | 0341 | 0365 | 0389 | 0413 |      |
| R0157-01       | h6        | 100 |   |     |   |     |      |      |      |      | 0254 | 0286 | 0318 | 0342 | 0366 | 0390 | 0414 |      |
| R0157-01       | m6        | 100 |   |     |   |     |      |      |      |      | 0255 | 0287 | 0319 | 0343 | 0367 | 0391 | 0415 |      |
| R0157-01       | h6        | 120 |   |     |   |     |      |      |      |      |      | 0288 | 0320 | 0344 | 0368 | 0392 | 0416 |      |
| R0157-01       | m6        | 120 |   |     |   |     |      |      |      |      |      | 0289 | 0321 | 0345 | 0369 | 0393 | 0417 |      |
| R0157-01       | h6        | 140 |   |     |   |     |      |      |      |      |      |      | 0322 | 0346 | 0370 | 0394 | 0418 |      |
| R0157-01       | m6        | 140 |   |     |   |     |      |      |      |      |      |      | 0323 | 0347 | 0371 | 0395 | 0419 |      |
| R0157-01       | h6        | 150 |   |     |   |     |      |      |      |      |      |      |      | 0324 | 0348 | 0372 | 0396 | 0420 |
| R0157-01       | m6        | 150 |   |     |   |     |      |      |      |      |      |      |      | 0325 | 0349 | 0373 | 0397 | 0421 |